

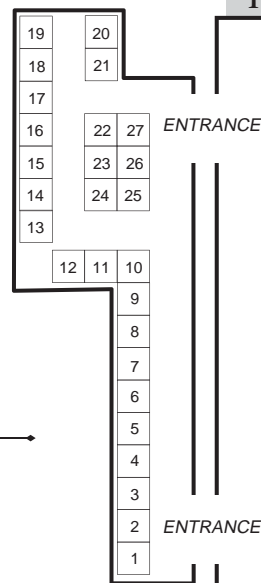

Sacramento Convention Center
January 26 - 28, 2010 • Exhibits: January 27 & 28

Outdoor Terrace
Tented Pavilion



Third Floor - Ballroom & Outdoor Terrace

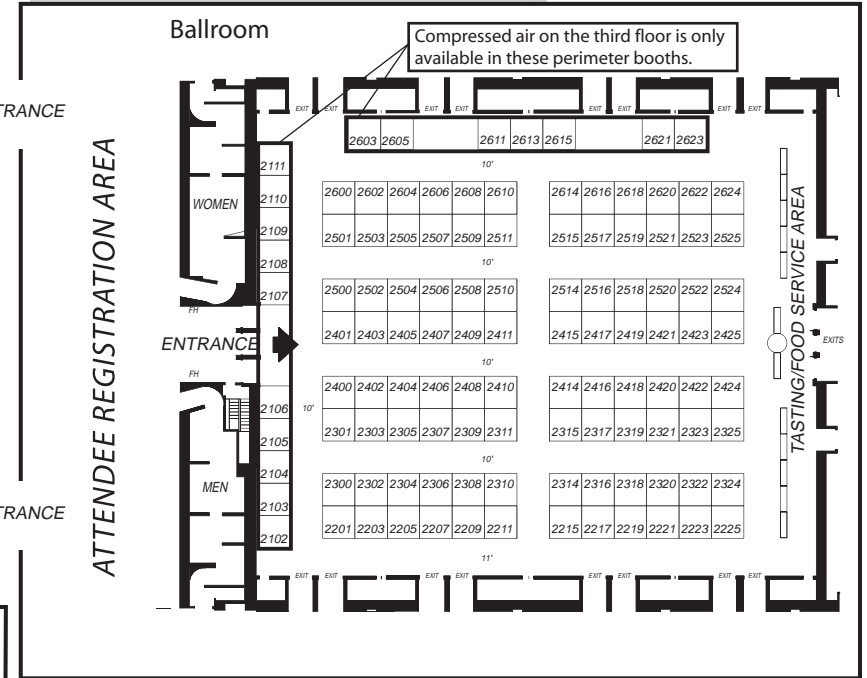

First Floor

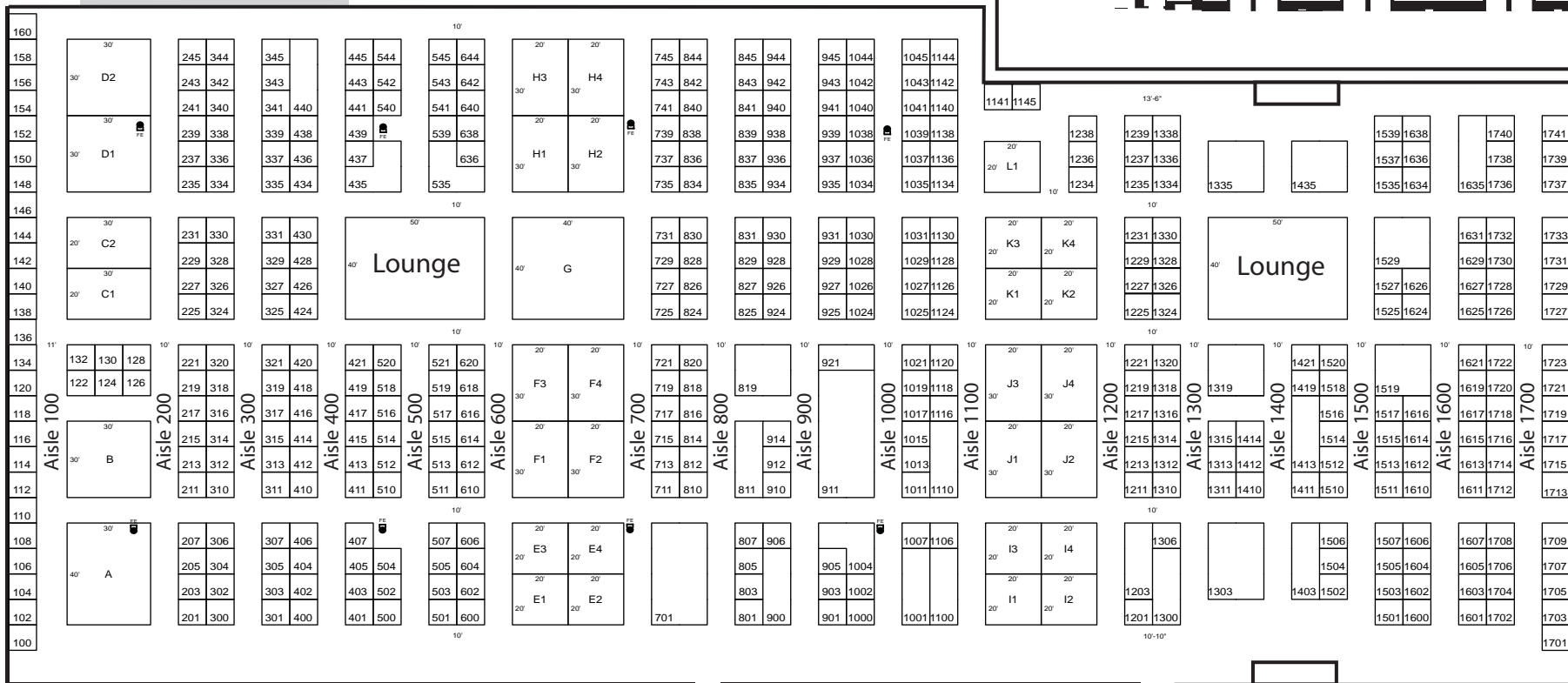

Facility Ceiling/Door Dimensions & Floor Load:

- Ceiling Height**
 Hall A - 30'; Hall B - 30';
 Hall C-E - 19'
 3rd Floor Ballroom - 25';
 Outdoor Terrace - 8'
- Floor Load**
 Exhibit Halls A-E -
 350 lbs. per sq. ft.
 3rd Floor Ballroom and
 Outdoor Terrace - 150 lbs. per
 sq. ft.

Freight Door Dimensions

- 17' 8" wide x 15' 6" high

Freight Elevator Dimensions

- 7' wide x 16' long x 9' high

Freight Elevator Maximum Weight Allowed

- 15,000 lbs.

3rd Floor Ballroom and Outdoor Terrace Access Door Dimensions

- 5' 10" wide x 7' 8" high

(Weight distribution approval required by Sacramento Convention Center and show decorators.)

Floor plan subject to change without notice

ENTRANCE

ENTRANCE

Modified 8/18/2009